



# **GUIL<sup>®</sup>**

## MATERIAL LIFTS



[www.guil-lifters.com](http://www.guil-lifters.com)

MADE IN SPAIN



# GUIL® Engineering for Lifting Loads

GUIL is a Spanish manufacturer with over 35 years of experience in the metal industry, specialised in the design and production of IMaterial Lifting Towers for industrial use (for maintenance, installation and construction companies), which are characterised as being highly innovative, efficient and safe.

Our head office is found at our premises in L'Alcúdia, a town that is only 30 km from the region's capital, Valencia (Spain) with more than 5000 m<sup>2</sup> for our design and project offices, our prototype and testing workshops, our factory and machinery areas (cutting, welding, painting, assembly etc.), quality control department, warehouse and packing departments, sales and marketing departments and our customer service department.

At the heart of our company is our technical team of engineers who are dedicated to developing lifting towers and wind-up stands of the highest quality and efficiency, and our sales and post-sale staff who offer a fast, competent and professional customer service.

We manufacture over 30 models of lifting towers with compact designs which offer the user a safe and practical option to lift many types of loads. Thanks to this wide range of models and their versatility to be used for so many different tasks along with our adaptors designed for functionality, our towers can be used in numerous fields and are well known for their high quality and durability.

Since 1983 GUIL has experienced a fast and constant evolution and growth, quickly adapting to the ever changing market requirements and continuously improving our manufacturing systems. Thanks to our large distributor network over the 5 continents and our presence at the main national and international trade shows GUIL export just over 89% of their total production to over 90 countries worldwide.

## Choose a model and Lift your load

GUIL manufactures Material lifters that offer:

- Maximum stability, safety and resistance. Maximum Safety & Durability
- Timesaving > 100% Productivity
- Lifts of small size – Easy load in vehicles
- Greater manoeuvrability for an easy, safe and convenient Lift operation.
- Fast and easy set-up with no tools required. There are no loose parts
- Compact and lightweight designs for an easy handling. One person operation
- Domestic and industrial applications. Indoor & outdoor uses
- Maximum versatility. A wide range of accessories & adapters available to fulfil all lifting needs
- Portable designs for an easy transportation and storage in small places. Corridor and single-door access
- Sturdy steel base (Epoxy coated for outside uses) with non-marring castors
- Made in Spain – 100 % Service. Availability of all accessories & spare parts!
- Brake winches that lock the load in place when handle/s is/are released.
- Manual winches provided with one or two removable handles for easy lift storage.
- Lifts are equipped with three Safety Systems to guarantee maximum reliability (triple margin of safety).
- Aluminium and steel sturdy but light construction designed to lift, position and install a large variety of materials.
- Reversible forks for added height and get a better load positioning.
- All range of Lifts comply with the European standards guaranteeing maximum safety and resistance.



### GUIL - Innovative ideas in Lifting Engineering

# Comparative table



## ELC MODELS



REFERENCE	Maximum Height	Maximum Load	Height Stowed
ELC-710	4,00 m 13 ft 1 in	100 Kg 220 lb	1,65 m 5 ft 4 in
ELC-720	3,50 m 11 ft 6 in	125 Kg 276 lb	1,35 m 4 ft 5 in
ELC-630/R	4,56 m 14 ft 12 in	125 Kg 276 lb	1,45 m 4 ft 10 in
ELC-750	4,50 m 14 ft 9 in	150 Kg 330 lb	1,48 m 4 ft 10 in
ELC-770	5,20 m 17 ft 1 in	250 Kg 551 lb	1,75 m 5 ft 9 in
ELC-780	5,20 m 17 ft 1 in	280 Kg 617.29 lb	1,75 m 5 ft 9 in



## TORO A-RANGE



REFERENCE	Maximum Height	Maximum Load	Height Stowed
TORO A-101/C	2,90 m 9 ft 6 in	150 Kg 331 lb	1,77 m 5 ft 10 in

## TORO B-RANGE



REFERENCE	Maximum Height	Maximum Load	Height Stowed
TORO B-201/C	4,00 m 3 ft 1 in	200 Kg 441 lb	1,68 m 5 ft 6 in
TORO B-202/C	5,15 m 16 ft 11 in	200 Kg 441 lb	1,68 m 5 ft 6 in
TORO B-203/C	6,30 m 20 ft 8 in	200 Kg 441 lb	1,68 m 5 ft 6 in

## TORO C-RANGE



REFERENCE	Maximum Height	Maximum Load	Height Stowed
TORO C-301/C	3,85 m 12 ft 8 in	300 Kg 661 lb	1,61 m 5 ft 3 in
TORO C-302/C	5,00 m 16 ft 5 in	300 Kg 661 lb	1,61 m 5 ft 3 in
TORO C-303	5,00 m 16 ft 5 in	300 Kg 661 lb	1,99 m 6 ft 6 in
TORO C-304/C	6,00 m 19 ft 8 in	250 Kg 551 lb	1,61 m 5 ft 3 in
TORO C-305	6,50 m 21 ft 4 in	300 Kg 661 lb	1,99 m 6 ft 6 in
TORO C-306	8,00 m 26 ft 3 in	280 Kg 617 lb	1,99 m 6 ft 6 in

## TORO D-RANGE



REFERENCE	Maximum Height	Maximum Load	Height Stowed
TORO D-401	3,55 m 11 ft 8 in	400 Kg 882 lb	1,99 m 6 ft 6 in
TORO D-402/C	3,85 m 12 ft 8 in	400 Kg 882 lb	1,61 m 5 ft 3 in
TORO D-403/C	5,00 m 16 ft 5 in	400 Kg 882 lb	1,61 m 5 ft 3 in
TORO D-404	5,00 m 16 ft 5 in	400 Kg 882 lb	1,99 m 6 ft 6 in
TORO D-405/C	6,00 m 19 ft 8 in	350 Kg 772 lb	1,61 m 5 ft 3 in
TORO D-406	6,50 m 21 ft 4 in	400 Kg 882 lb	1,99 m 6 ft 6 in
TORO D-407	8,00 m 26 ft 3 in	350 Kg 772 lb	1,99 m 6 ft 6 in



Ø 35 mm  
Top spigot

**BC-02/H**  
Loading platform  
80 x 40 cm  
(NOT INCLUDED)



**R-710**  
Set of 3 castors  
(Not included)

REFERENCE	Maximum Height	Maximum Load	Height Stowed	Net Weight
ELC-710	4.00 m 13 ft 1 in	100 kg 220 lb	1.65 m 5 ft 4 in	20.5 Kg 45 lb



**BC-02/M**

Loading platform (80 x 40cm)  
(Not included)

**R-720**

Set of 2 double castors per leg  
(1 with brake) for ELC-720  
material lift



**ASB**  
SYSTEM



REFERENCE	Maximum Height	Maximum Load	Height Stowed	Net Weight
ELC-720	3.50 m 11 ft 6 in	125 kg 276 lb	1.35 m 4 ft 5 in	23,5 Kg 51.8 lb

(Castors not included)





**BC-02/M**  
Loading platform (80 x 40cm)  
(Not included)



REFERENCE	Maximum Height	Maximum Load	Height Stowed	Net Weight
ELC-630/R	4.56 m 14 ft 12 in	125 kg 276 lb	1.45 m 4 ft 10 in	37 Kg 82 lb

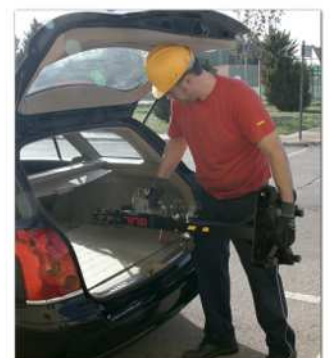



For adaptors with a  
Ø 35 mm spigot.



**BC-02/M**  
Loading platform  
80 x 40 cm  
(NOT INCLUDED)



REFERENCE	Maximum Height	Maximum Load	Height Stowed	Net Weight
ELC-750	4.50 m 14 ft 9 in	150 kg 330 lb	1.48 m 4 ft 10 in	49.5 Kg 109 lb



**BC-02/M2**  
Loading platform  
80 x 40 cm  
(NOT INCLUDED)

For adaptors with a  
Ø 50-55 mm spigot.



REFERENCE	Maximum Height	Maximum Load	Height Stowed	Net Weight
ELC-770	5.20 m 17 ft 1 in	250 kg 551 lb	1.75 m 5 ft 9 in	89 Kg 196 lb





**BC-02/M2**  
Loading platform  
80 x 40 cm  
(NOT INCLUDED)

For adaptors with a  
Ø 50-55 mm spigot.



REFERENCE	Maximum Height	Maximum Load	Height Stowed	Net Weight
ELC-780	5.20 m 17 ft 1 in	280 kg 617 lb	1.75 m 5 ft 9 in	89 Kg 196 lb

# ADAPTORS & ACCESSORIES ELC

## BC-02 LOADING TRAY-SELF



800 x 400 mm

## BC-06 LOADING TRAY-SELF



450 x 450 mm

## CPS-01 LEG ADAPTORS



Set of 3 leg adaptors

## CPS-02 LEG ADAPTORS



Set of 4 leg adaptors



## BC-05 LOADING TRAY-SELF



740 x 435 x 140 mm

Folded Dimensions:  
450 x 435 x 150 mm



ALUMINIUM

## BC-07 LOADING TRAY-SELF



450 x 435 x 140 mm

Folded Dimensions:  
450 x 230 x 150 mm



ALUMINIUM

## RD-01 WHEEL ADAPTOR FOR MATERIAL LIFTER Ref. ELC-630/R



Adaptor with 2 wheels  
(Ø 170 mm)

## R-710 WHEELS FOR MATERIAL LIFTER Ref. ELC-710



Set of 3 wheels



## R-720 WHEELS FOR MATERIAL LIFTER Ref. ELC-720



Set of 4 wheels



## FCA-04

## ADAPTORS TO RAISE FLOOD LIGHTS

## FCA-06



# TORO A-Range Material Lifts



	<b>TORO A-101/C</b>
+↑	2.90 m 9 ft 6 in
⬇️	150 kg 331 lb
-↓	1.77 m 5 ft 10 in
⬆️	56.5 Kg 125 lb

# TORO A-Range Details

## TORO MATERIAL LIFTS ARE EQUIPPED WITH TWO SAFETY SYSTEMS



Auto-brake winches.  
CE Machinery Directives



Internal Pendulum  
Brake System (IPB)



Mast Section Unblocking  
System (MSU)

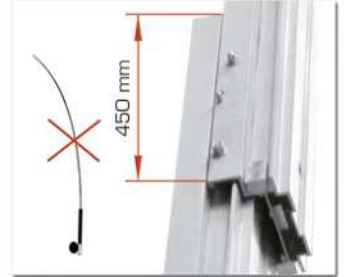

More mast overlap.  
Prevent fishing rod effect



Adjustable manoeuvring handles  
with wheels.



Reinforced forks included.  
(Detachable). Reversible &  
Adjustable design.



2 Stabiliser braces  
for greater lift stability.



Adjustable mast blocking  
system for horizontal  
transportation.



Adjustable base



Large wheels for  
easy manoeuvring



### COMPACT DESIGNS



# TORO A-Range Specifications

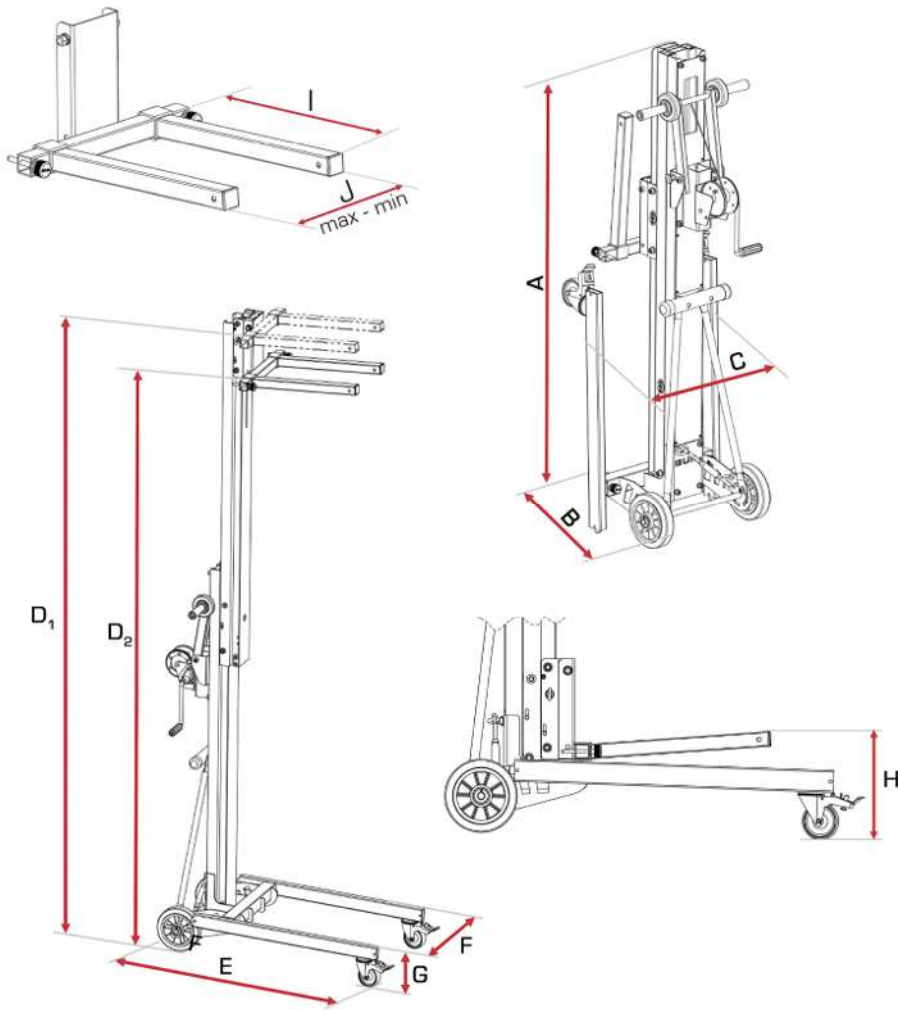

TORO A - Range		TORO A-101/C
<b>STOWED</b>		
Height (cm/ft)	A	177 / 5.8
Length (cm/ft)	B	50 / 1.6
Width (cm/ft)	C	57 / 1.9
<b>DESPLEGADA</b>		
Maximum Forks up height (cm/ft)	D <sub>1</sub>	290 / 9.5
Forks down	D <sub>2</sub>	270 / 8.9
Length (cm/ft)	E	115 / 3.8
Maximum width (cm/ft)	F <sub>MAX</sub>	75 / 2.5
Minimum width (cm/ft)	F <sub>min</sub>	57 / 1.9
Leg height (cm/ft)	G	19 / 0.62
Load height (cm/ft)	H	30 / 1
<b>HORQUILLAS</b>		
Length (cm/in)	I	50 / 19.7
Maximum width (cm/in)	J <sub>MAX</sub>	41 / 16
Minimum width (cm/in)	J <sub>min</sub>	22 / 8.7
Number of sections	2	
Maximum load (Kg/lbs)	150 / 331	
Weight (Kg/lbs)	56.5 / 125	



# TORO B-Range Material Lifts



	<b>TORO B-201/C</b>	<b>TORO B-202/C</b>	<b>TORO B-203/C</b>
+↑	4.00 m 3 ft 1 in	5.15 m 16 ft 11 in	6.30 m 20 ft 8 in
⬇️⬆️ kg	200 kg 441 lb	200 kg 441 lb	200 kg 441 lb
-↓	1.68 m 5 ft 6 in	1.68 m 5 ft 6 in	1.68 m 5 ft 6 in
⬆️⬇️ kg	114 Kg 251 lb	124 Kg 273 lb	134 Kg 295 lb

# TORO B-Range Details

TORO MATERIAL LIFTS ARE EQUIPPED WITH TWO SAFETY SYSTEMS



Auto-brake winch.  
CE Machinery Directives



Internal Pendulum  
Brake System (IPB)



Mast Section Unblocking  
System (MSU)



More mast overlap.  
Prevents fishing rod effect



Adjustable manoeuvring handle  
with wheels included.



Reinforced forks included.  
(Detachable). Reversible  
& Adjustable design.



2 Stabiliser braces for  
greater lift stability.



Adjustable mast blocking  
system for horizontal trans-  
portation.



Spirit level



Folding side legs included



Adjustable legs

Legs can be inserted in  
the front or back of the  
tower for positioning close  
to walls.

Compact designs and 12 wheels included for  
easy manoeuvring (Vertically and horizontally)



Ø150 mm adjustable wheels  
for perfect levelling.



# TORO B-Range Specifications

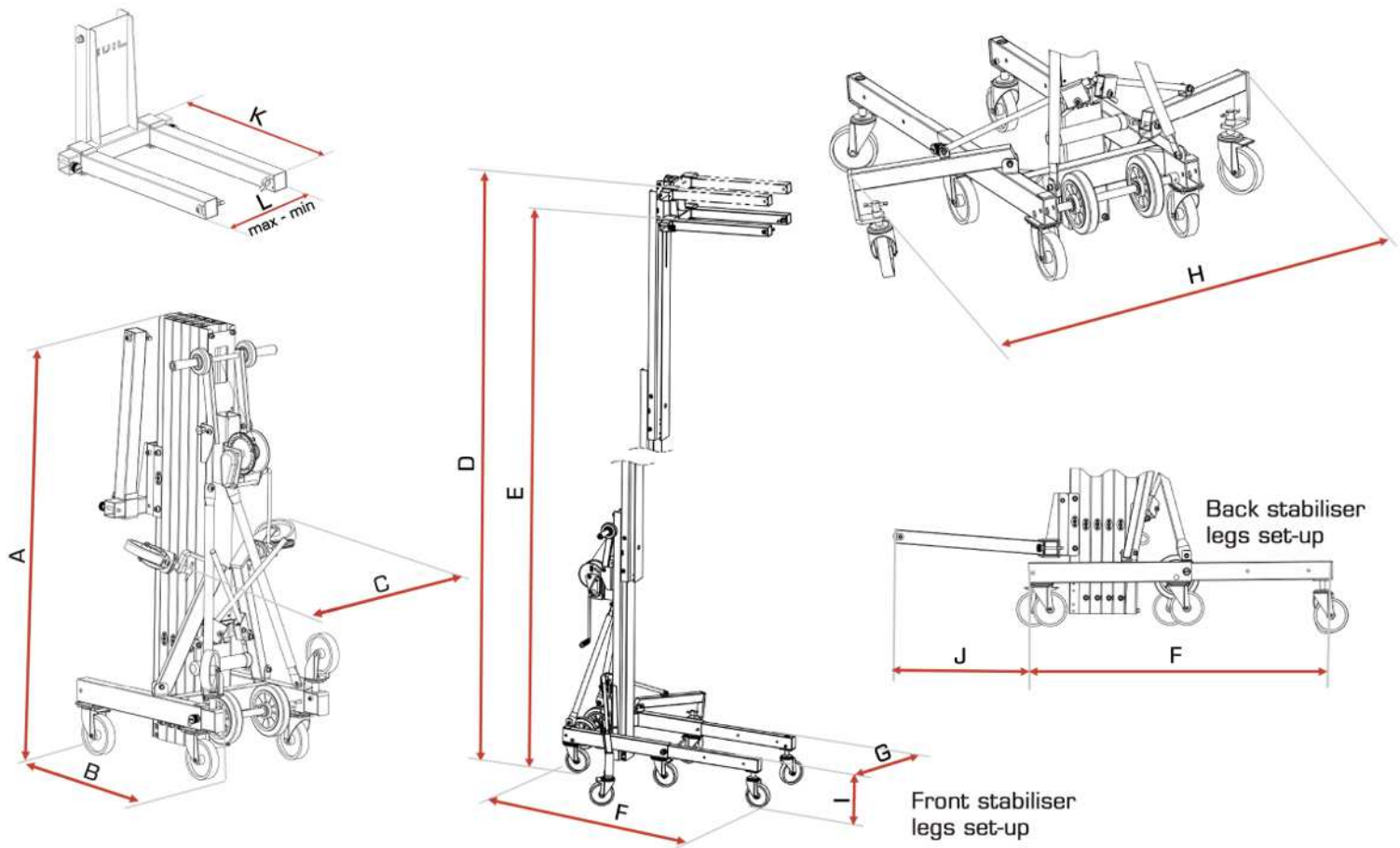

TORO B - Range		TORO B-201/C	TORO B-202/C	TORO B-203/C
<b>STOWED</b>				
Height (cm/ft)	A	168 / 5.5	168 / 5.5	168 / 5.5
Length (cm/ft)	B	84 / 2.8	84 / 2.8	84 / 2.8
Width (cm/ft)	C	75.5 / 2.5	75.5 / 2.5	75.5 / 2.5
<b>WORKING MEASUREMENTS</b>				
Maximum height – Forks up (cm/ft)	D	400 / 13.1	515 / 16.9	630 / 20.7
Maximum height – Forks down (cm/ft)	E	380 / 12.5	495 / 16.2	610 / 20
Length (cm/ft)	F	138 / 4.5	138 / 4.5	138 / 4.5
Width (cm/ft)	G	60 / 2	60 / 2	60 / 2
Width with stabilisers unfolded (cm/ft)	H	145 / 4.8	145 / 4.8	145 / 4.8
Load height (cm/ft)	I	30 / 1	30 / 1	30 / 1
Distance to the wall (cm/ft)	J	58.5 / 1.9	58.5 / 1.9	58.5 / 1.9
<b>FORKS</b>				
Length (cm/ft)	K	66 / 2.2	66 / 2.2	66 / 2.2
Maximum width (cm/ft)	L <sub>max</sub>	38 / 1.2	38 / 1.2	38 / 1.2
Minimum width (cm/ft)	L <sub>min</sub>	28 / 0.9	28 / 0.9	28 / 0.9
<b>PERFORMANCE</b>				
Number of sections		3	4	5
Maximum load (Kg/lbs)		200 / 441	200 / 441	200 / 441
Weight (Kg/lbs)		114 / 251	124 / 273	134 / 295



# TORO C-Range Material Lifts



	<b>TORO C-301/C</b>	<b>TORO C-302/C</b>	<b>TORO C-303</b>	<b>TORO C-304/C</b>	<b>TORO C-305</b>	<b>TORO C-306</b>
↑	3.85 m 12 ft 8 in	5.00 m 16 ft 5 in	5.00 m 16 ft 5 in	6.00 m 19 ft 8 in	6.50 m 21 ft 4 in	8.00 m 26 ft 3 in
↕	300 kg 661 lb	300 kg 661 lb	300 kg 661 lb	250 kg 551 lb	300 kg 661 lb	280 kg 617 lb
↓	1.61 m 5 ft 3 in	1.61 m 5 ft 3 in	1.99 m 6 ft 6 in	1.61 m 5 ft 3 in	1.99 m 6 ft 6 in	1.99 m 6 ft 6 in
Ⓚ	166 Kg 364 lb	179 Kg 395 lb	174 Kg 384 lb	193 Kg 426 lb	191 Kg 421 lb	208 Kg 459 lb

# TORO C-Range Details

TORO MATERIAL LIFTS ARE EQUIPPED WITH TWO SAFETY SYSTEMS



Auto-brake winch.  
CE Machinery Directives



Internal Pendulum  
Brake System (IPB)



Mast Section Unblocking  
System (MSU)

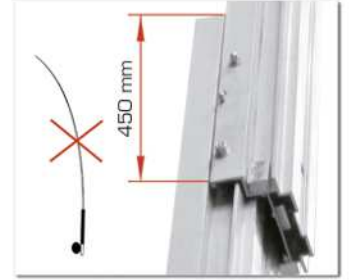

More mast overlap.  
Prevents fishing rod effect



Adjustable manoeuvring  
handle with Ø200 mm  
wheels included.  
(3 positions)



Reinforced forks included.  
(Detachable). Reversible &  
Adjustable design.



2 Stabiliser braces for  
greater lift stability.



Adjustable mast blocking  
system for horizontal transpor-  
tation.



Spirit  
level



Legs can be inserted in the front or  
back of the tower for positioning  
close to walls.

Folding side  
legs included



Adjustable legs

Compact designs and 12 wheels included for  
easy manoeuvring (Vertically and horizontally)



Ø150 mm adjustable wheels  
for perfect levelling.



# TORO Serie-C Specifications

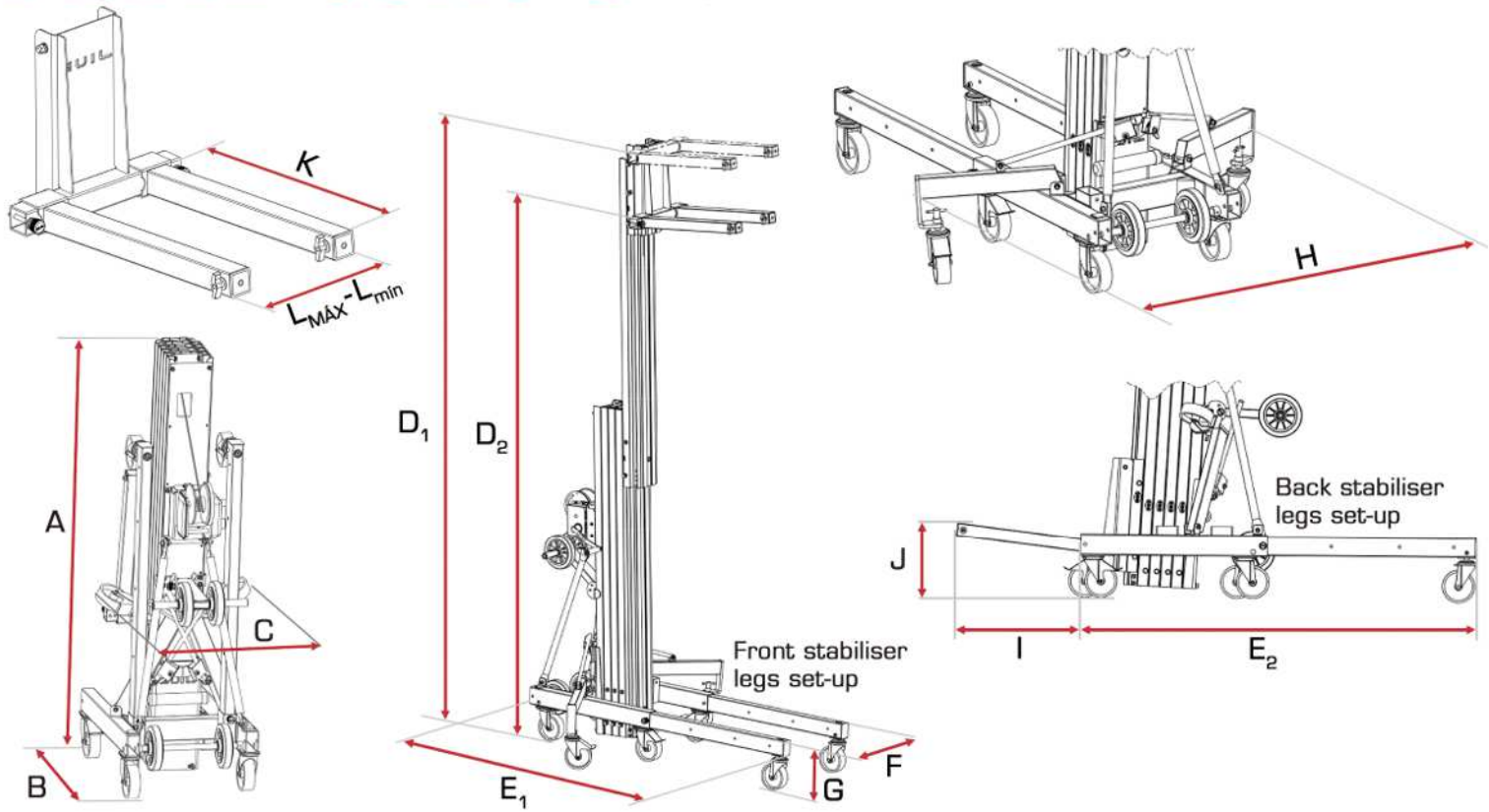

TORO C - Range			TORO C-301/C	TORO C-302/C	TORO C-303	TORO C-304/C	TORO C-305	TORO C-306
<b>STOWED</b>								
Height (cm/ft)	A		161 / 5.3	161 / 5.3	199 / 6.5	161 / 5.3	199 / 6.5	199 / 6.5
Length (cm/ft)	B		95 / 3.1	95 / 3.1	95 / 3.1	95 / 3.1	95 / 3.1	95 / 3.1
Width (cm/ft)	C		65 / 2.1	65 / 2.1	65 / 2.1	65 / 2.1	65 / 2.1	65 / 2.1
<b>WORKING MEASUREMENTS</b>								
Maximum height (cm/ft)	Forks up	D <sub>1</sub>	385 / 12.6	500 / 16.4	500 / 16.4	600 / 19.7	650 / 21.3	800 / 26.2
	Forks down	D <sub>2</sub>	343 / 11.3	458 / 15	458 / 15	558 / 18.3	608 / 19.9	758 / 24.9
Length (cm/ft)	Front legs	E <sub>1</sub>	192 / 6.3	192 / 6.3	192 / 6.3	192 / 6.3	192 / 6.3	192 / 6.3
	Back legs	E <sub>2</sub>	183 / 6	183 / 6	183 / 6	183 / 6	183 / 6	183 / 6
Width (cm/ft)		F	64.5 / 2.1	64.5 / 2.1	64.5 / 2.1	64.5 / 2.1	64.5 / 2.1	64.5 / 2.1
Leg height (cm/ft)		G	30 / 1	30 / 1	30 / 1	30 / 1	30 / 1	30 / 1
Width with stabilisers unfolded (cm/ft)		H	147 / 4.8	147 / 4.8	147 / 4.8	147 / 4.8	147 / 4.8	147 / 4.8
Distance to the wall (cm/ft)		I	57 / 1.9	57 / 1.9	57 / 1.9	57 / 1.9	57 / 1.9	57 / 1.9
Load height (cm/ft)		H	33 / 1.1	33 / 1.1	33 / 1.1	33 / 1.1	33 / 1.1	33 / 1.1
<b>FORKS</b>								
Length (cm/in)		K	66 / 26	66 / 26	66 / 26	66 / 26	66 / 26	66 / 26
Maximum width (cm/in)		L <sub>MAX</sub>	47.5 / 18.7	47.5 / 18.7	47.5 / 18.7	47.5 / 18.7	47.5 / 18.7	47.5 / 18.7
Minimum width (cm/in)		L <sub>min</sub>	33.5 / 13.2	33.5 / 13.2	33.5 / 13.2	33.5 / 13.2	33.5 / 13.2	33.5 / 13.2
Number of sections			3	4	3	5	4	5
Maximum load (Kg/lbs)			300 / 661	300 / 661	300 / 661	250 / 551	300 / 661	280 / 617
Weight (Kg/lbs)			166 / 366	179 / 395	173 / 381	193 / 426	191 / 421	208 / 459

# TORO D-Range Material Lifts



	TORO D-401	TORO D-402/C	TORO D-403/C	TORO D-404	TORO D-405/C	TORO D-406	TORO D-407
↑	3.55 m 11 ft 8 in	3.85 m 12 ft 8 in	5.00 m 16 ft 5 in	5.00 m 16 ft 5 in	6.00 m 19 ft 8 in	6.50 m 21 ft 4 in	8.00 m 26 ft 3 in
kg ↓	400 kg 882 lb	400 kg 882 lb	400 kg 882 lb	400 kg 882 lb	350 kg 772 lb	400 kg 882 lb	350 kg 772 lb
↓	1.99 m 6 ft 6 in	1.61 m 5 ft 3 in	1.61 m 5 ft 3 in	1.99 m 6 ft 6 in	1.61 m 5 ft 3 in	1.99 m 6 ft 6 in	1.99 m 6 ft 6 in
kg	165 Kg 364 lb	175 Kg 386 lb	191 Kg 421 lb	184 Kg 406 lb	207 Kg 456 lb	203 Kg 448 lb	220 Kg 485 lb

# TORO D-Range Details

TORO MATERIAL LIFTS ARE EQUIPPED WITH TWO SAFETY SYSTEMS



Auto-brake winch with double handle. CE Machinery Directives



Internal Pendulum Brake System (IPB)



Mast Section Unblocking System (MSU)

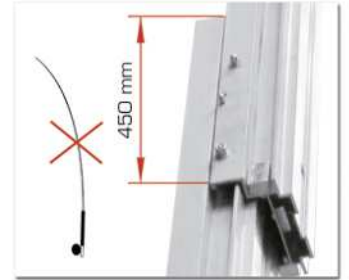

More mast overlap. Prevents fishing rod effect



Adjustable manoeuvring handle with Ø200 mm wheels included. (3 positions)



Reinforced forks included. (Detachable). Reversible & Adjustable design.



2 Stabiliser braces for greater lift stability.



Adjustable mast blocking system for horizontal transportation.



Spirit level



Legs can be inserted in the front or back of the tower for positioning close to walls.

Folding side legs included



Adjustable legs

Compact designs and 12 wheels included for easy manoeuvring (Vertically and horizontally)



Ø150mm adjustable wheels for perfect levelling.



# TORO Serie-D Specifications

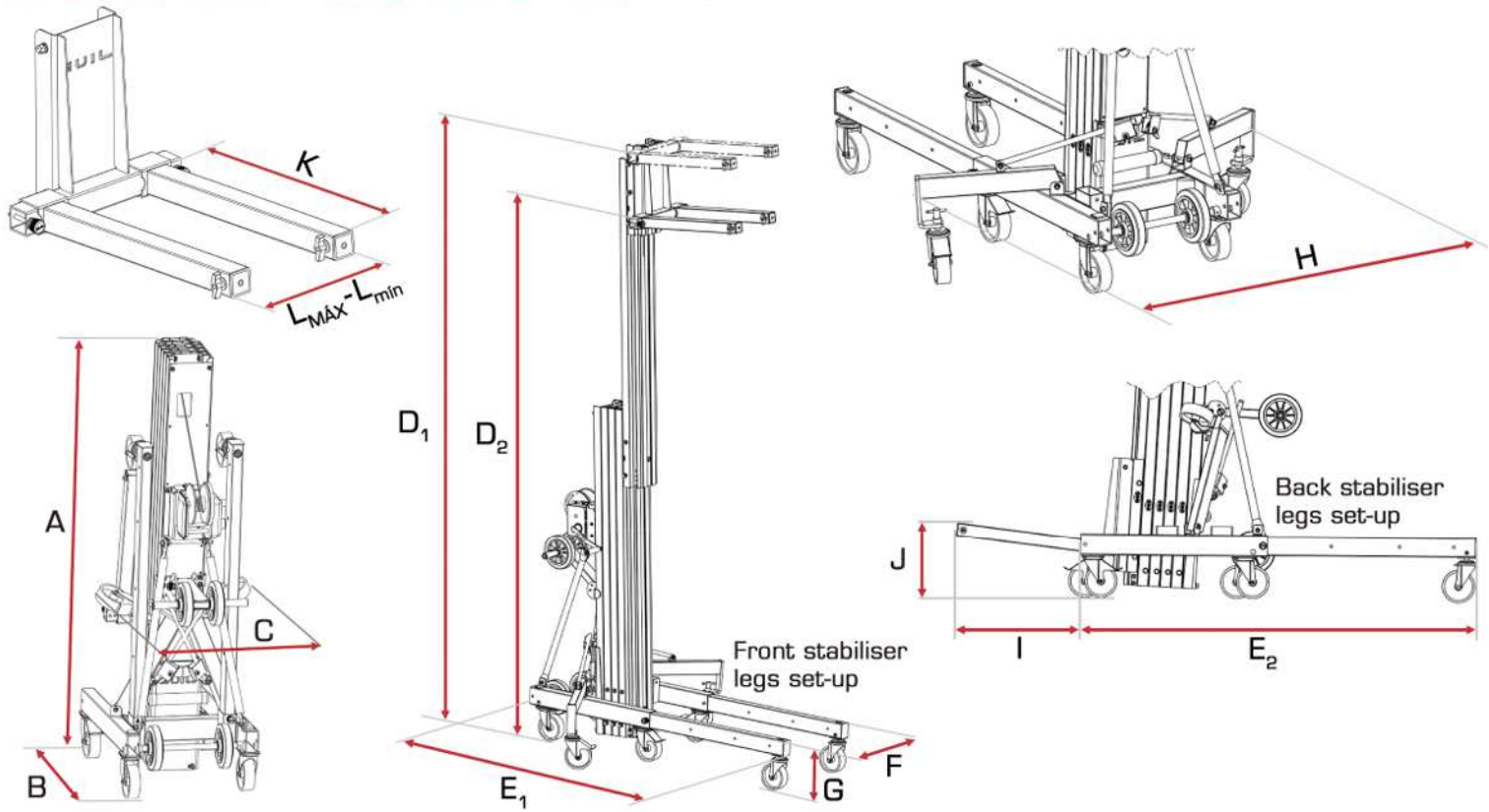

TORO D - Range		TORO D-401	TORO D-402/C	TORO D-403/C	TORO D-404	TORO D-405/C	TORO D-406	TORO D-407	
<b>STOWED</b>									
Height (cm/ft)	A	199 / 6.5	161 / 5.3	161 / 5.3	199 / 6.5	161 / 5.3	199 / 6.5	199 / 6.5	
Length (cm/ft)	B	95 / 3.1	95 / 3.1	95 / 3.1	95 / 3.1	95 / 3.1	95 / 3.1	95 / 3.1	
Width (cm/ft)	C	65 / 2.1	65 / 2.1	65 / 2.1	65 / 2.1	65 / 2.1	65 / 2.1	65 / 2.1	
<b>WORKING MEASUREMENTS</b>									
Maximum height (cm/ft)	Forks up	D <sub>1</sub>	355 / 11.7	385 / 12.6	500 / 16.4	500 / 16.4	600 / 19.7	650 / 21.3	800 / 26.2
	Forks down	D <sub>2</sub>	315 / 10.3	345 / 11.3	460 / 15.1	460 / 15.1	560 / 18.4	610 / 20	760 / 24.9
Length (cm/ft)	Front legs	E <sub>1</sub>	192 / 6.3	192 / 6.3	192 / 6.3	192 / 6.3	192 / 6.3	192 / 6.3	192 / 6.3
	Back legs	E <sub>2</sub>	183 / 6	183 / 6	183 / 6	183 / 6	183 / 6	183 / 6	183 / 6
Width (cm/ft)		F	64.5 / 2.1	64.5 / 2.1	64.5 / 2.1	64.5 / 2.1	64.5 / 2.1	64.5 / 2.1	64.5 / 2.1
Leg height (cm/ft)		G	30 / 1	30 / 1	30 / 1	30 / 1	30 / 1	30 / 1	30 / 1
Width with stabilisers unfolded (cm/ft)		H	147 / 4.8	147 / 4.8	147 / 4.8	147 / 4.8	147 / 4.8	147 / 4.8	147 / 4.8
Distance to the wall (cm/ft)		I	57 / 1.9	57 / 1.9	57 / 1.9	57 / 1.9	57 / 1.9	57 / 1.9	57 / 1.9
Load height (cm/ft)		J	33 / 1.1	33 / 1.1	33 / 1.1	33 / 1.1	33 / 1.1	33 / 1.1	33 / 1.1
<b>FORKS</b>									
Length (cm/in)		K	66 / 26	66 / 26	66 / 26	66 / 26	66 / 26	66 / 26	66 / 26
Maximum width (cm/in)		L <sub>MAX</sub>	47.5 / 18.7	47.5 / 18.7	47.5 / 18.7	47.5 / 18.7	47.5 / 18.7	47.5 / 18.7	47.5 / 18.7
Minimum width (cm/in)		L <sub>min</sub>	35.5 / 14	35.5 / 14	35.5 / 14	35.5 / 14	35.5 / 14	35.5 / 14	35.5 / 14
Number of sections			2	3	4	3	5	4	5
Maximum load (Kg/lbs)			400 / 882	400 / 882	400 / 882	400 / 882	350 / 772	400 / 882	350 / 772
Weight (Kg/lbs)			165 / 364	175 / 386	191 / 421	184 / 406	207 / 456	203 / 448	220 / 485

# ADAPTORS & ACCESSORIES TORO

**HRT** FORK



**ACT-01** PIPE CRADLE



**ACT-04** LOAD PLATFORM



**ACT-06** ADAPTOR FOR ROLLER DOOR & WINDOW SHUTTERS



**ACT-03** BOOM ARM



**ACT-05** HOOK



**ACT-02** FORK LENGTHENERS



**ACT-07** FLOOD LIGHT ADAPTOR



**CW-01/20**

20 KG  
COUNTERWEIGHT



**CB-01**

COUNTERWEIGHT HOLDER



## Electric Lifting System for TORO Lifters (B - C - D Ranges)

Practical and very safe system that gives the option to raise and lower the TORO material lifts electrically (ranges B, C and D); converting the manual towers into electric towers.

The 'ELECTRIC' system is a very useful accessory which allows you to quickly and effortlessly raise the TORO lifters guaranteeing utmost safety at all times.

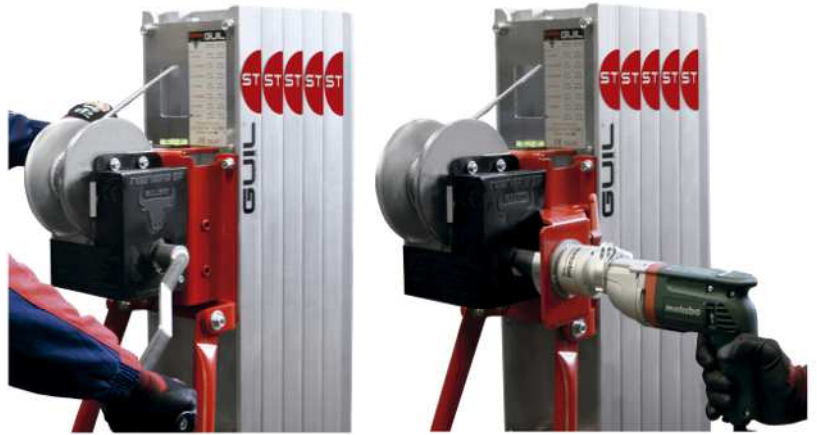

The accessory is made up of a 750W METABO drill and an adaptor to secure it to the hand winch on the lifter. The adaptor ensures a firm fix of the drill so that the user is not required to hold the drill in place. This detail not only makes it effortless to use but also prevents possible risk of bodily injuries.

The 'ELECTRIC' system is installed quickly and easily and have the following references depending on the tower it will be used with:

- TORO B-Range lifters – ref. ELECTRIC B
- TORO C-Range lifters – ref. ELECTRIC C
- TORO D-Range lifters – ref. ELECTRIC D



NOTE: When this electric system is used the TORO D-Range towers have a maximum load capacity of 350 kg.



# APPLICATIONS

GUIL manufactures a wide range of innovative material lifts, adapters and accessories designed to cover the needs for a large variety of applications:

## INSTALLATIONS

- \* Air conditioners
- \* Electric heaters
- \* Solar Panels
- \* Dry wall or false ceilings
- \* Electrical fixtures
- \* Roller shutters or awnings
- \* Ventilation systems
- \* Steel girders
- \* Piping
- \* Barrels and metal drums

## CONSTRUCTION - SIGNWORK

- \* Handling construction materials
- \* Handling pallets
- \* Installations of electric signs
- \* Big screens – Billboards

## MAINTENANCE WORK

- \* Hotels
- \* Airports
- \* Stadiums
- \* Maintenance companies

## STANDS & TRADE FAIRS

- \* Decorating stands
- \* Trade fair set-ups
- \* Conventions and conferences
- \* Big screens and displays
- \* LCD/Plasma screen stand

## MANUAL JOBS

- \* Metalwork
- \* Woodwork
- \* Aluminium framework



[www.guil-lifters.com](http://www.guil-lifters.com)

MADE IN SPAIN



P.I. La Creu C/ Ismael Tomás Alacreu, 28-30  
C.P.46250 L'Alcúdia (VALENCIA) SPAIN

Tel.+34 962996500  
Fax. +34 962540833

info@guil.es  
sales@guil.es



GUIL - YOUR EUROPEAN LIFTING TOWER MANUFACTURER